



Well presented apartment located on a popular development located close to Dunton Green railway station as well as local amenities. The property comprises open plan kitchen / living area, double bedroom and bathroom. Further benefits include allocated parking for one vehicle as well as access to an onsite gym.

11 Redlands Court

Eden Road, Dunton Green, Kent, TN14 5FW



B

£1,350 Per Calendar Month

Property Description

This one-bedroom apartment on the Ryewood Development is available soon. The apartment has been finished to a high specification with wooden floors in the entrance hall and reception room. The double bedroom has grey carpets and fitted wardrobes. There is a modern bathroom with a white suite and shower over the bath. The kitchen has charcoal coloured units, light wooden work surfaces and is fitted with appliances including a double oven, fridge freezer, and gas hob. There is also a good size cupboard in the hall which will house the washing machine and boiler. There is off street parking available for one vehicle.

Location

The property is in the lovely village of Dunton Green which is 2.5 miles from the centre of Sevenoaks with its selection of supermarkets, shops, restaurants, theatre, cafes, public houses and local artisan shops. Dunton Green itself provides local shopping and amenities with a Tesco superstore just under half a mile away in Riverhead. The area is renowned for its choice in schools for children of all ages. Transport links include Dunton Green station (from 26 minutes to London Bridge) which is 0.3 miles away and Sevenoaks station at a distance of 1.9 miles, as well as access to junction 5 of the M25 at 2.6 miles away. The village additionally benefits from having a local community centre along with tennis courts, a child's play park and a large open grass park for public use.

Directions

From our Sevenoaks office head north-west on London Road/A224. At the roundabout, take the 2nd exit onto London Road/A25. At the

next roundabout, continue straight onto London Road/A224. At the next roundabout, take the 2nd exit again and stay on London Road/A224. Continue Station Road. Take Campion Square to Eden Road and Redlands Court will be on your right.
what3words location finder - ///sugar.blank.overnight

Parking

One allocated parking space to the rear of the building in the gated courtyard.

Residents Gym And Woodland

There is a private on-site gym which is exclusive to residents of the Ryewood Development. In addition, there is an area of private woodland for the residents use as well as multiple seating areas and children's play areas within the attractively landscaped gardens and grounds.

Additional Information

Rent excludes the tenancy deposit and any other permitted payments. Holding Deposit of £311.53, based on the advertised rent, is required to reserve this property. Deposit payable is £1,557.69

Mains electric, water and drainage.

EPC Rating - B

Council Tax Band - C

Sevenoaks District Council

Viewings

Viewings are strictly via appointment with Kings only.

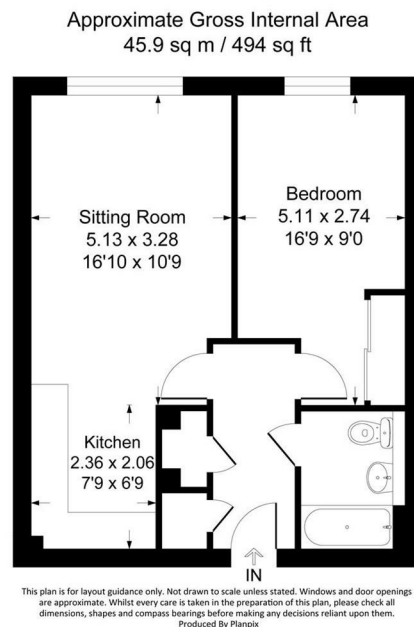

www.kings-estate-agents.co.uk

These particulars, whilst believed to be accurate are set out as a general outline only for guidance and do not constitute any part of an offer or contract. Intending purchasers should not rely on them as statements of representation of fact, but must satisfy themselves by inspection or otherwise as to their accuracy. No person in the firms employment has the authority to make or give any representation or warranty in respect of the property.

4 Station Parade, London Road, Sevenoaks, Kent,
TN13 1DL
T: 01732 740747

sevenoaks@kings-estate-agents.co.uk

kings-estate-agents.co.uk

